



« K » type Extension

Application : For « K » type temperature sensors
For LAMBDA sensor
For VALVE sensor

Length : **115cm / 45.3inch**

Connector : **Red**

Sticker : **Red**

Type : **Female**

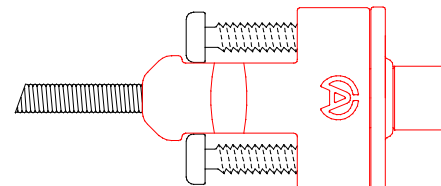
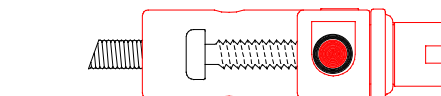
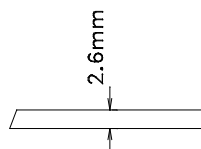
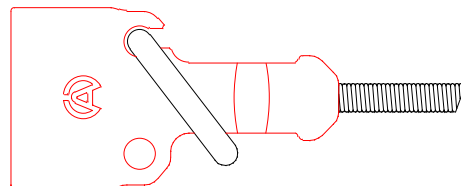
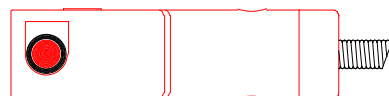

Connector : **Red**

Sticker : **Red**

Type : **Male**

ATTENTION : When fixing, take care to move away the most possible the wire of this sensor from the other wires, mainly from the type : RPM, high tension of the ignition system wires, to avoid reciprocal interferences.

Adjustings

PRO+ / A-141
PRO+ LV / A-145

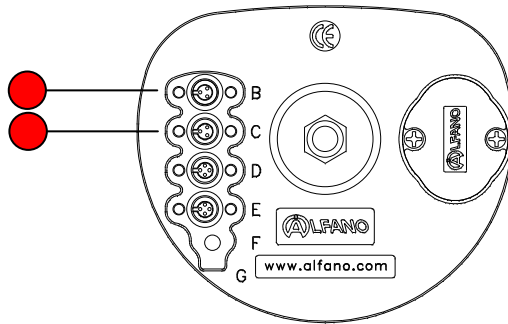

AStro / A-151
AStro 4T / A-152
AStro LV / A-155

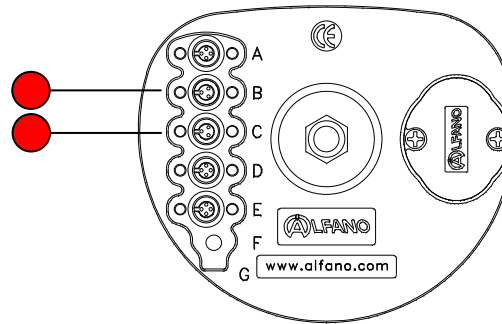

AStro formula / A-161
AStro formula 4T / A-162
AStro fomula LV / A-165

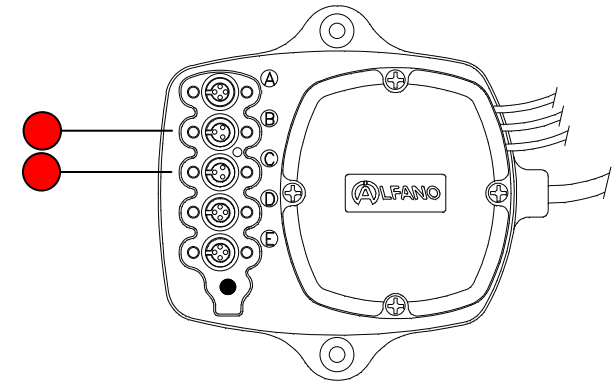

We apply a method of continuous development. Therefore, we reserve the right to bring changes and improvements to all products described in this document, without preliminary notice. Consult our website regularly www.alfano.com in order to be informed of the last news and/or changes.